

Window box

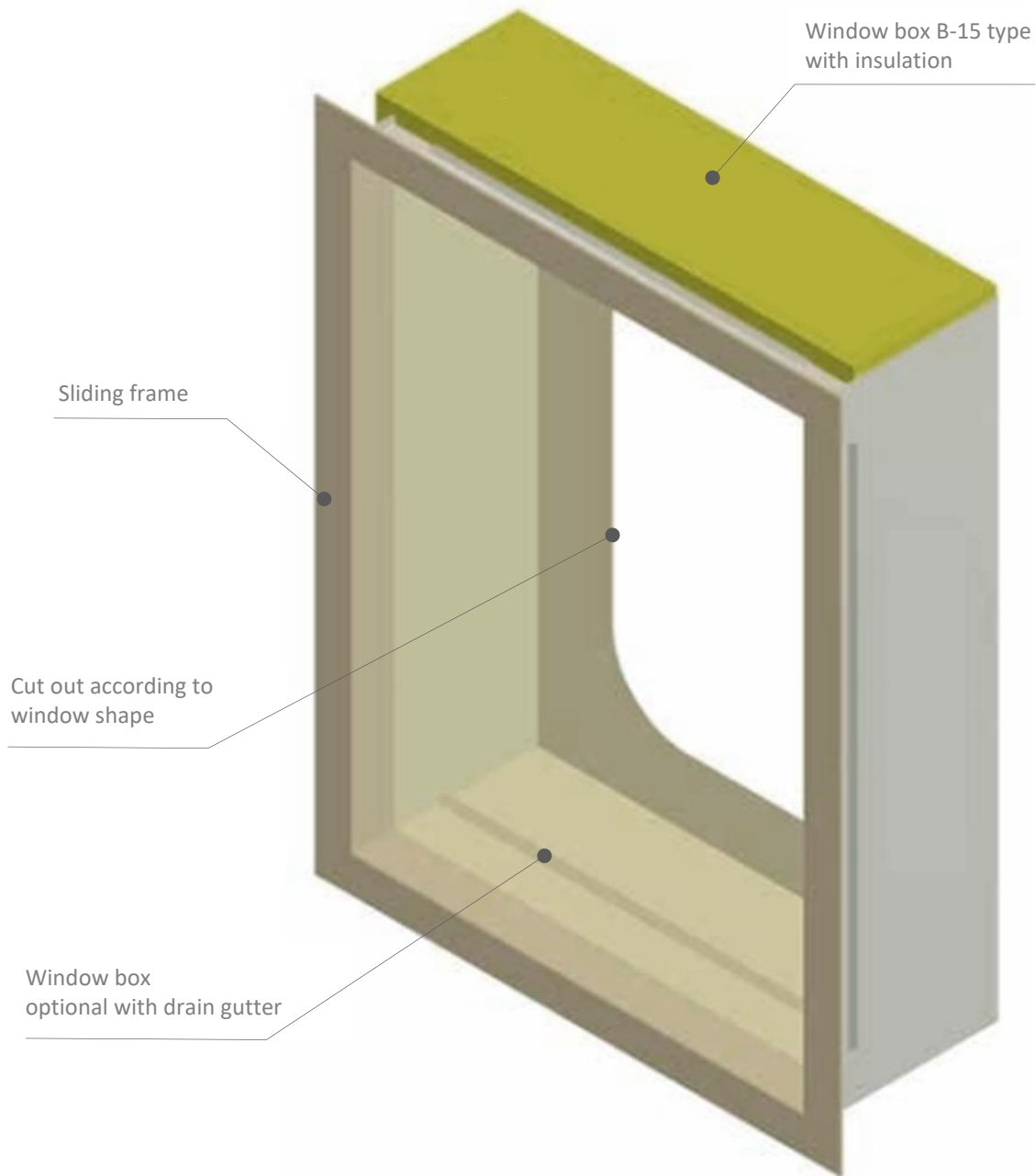

The window box provides the connection between the hull and the accommodation system. A piece of flat steel should be laid around the window before the window box is mounted to simplify installation. Window boxes can be supplied with prefabricated cut-outs for windows. A special steel outer sliding frame is used to compensate for tolerances. The window-box body is designed to resist natural vibrations. A large variety of surface finishes are available; all of them have a removable protective foil to prevent any damage from occurring during installation. The design of the window box and all components used have been tested and approved according to international standards.

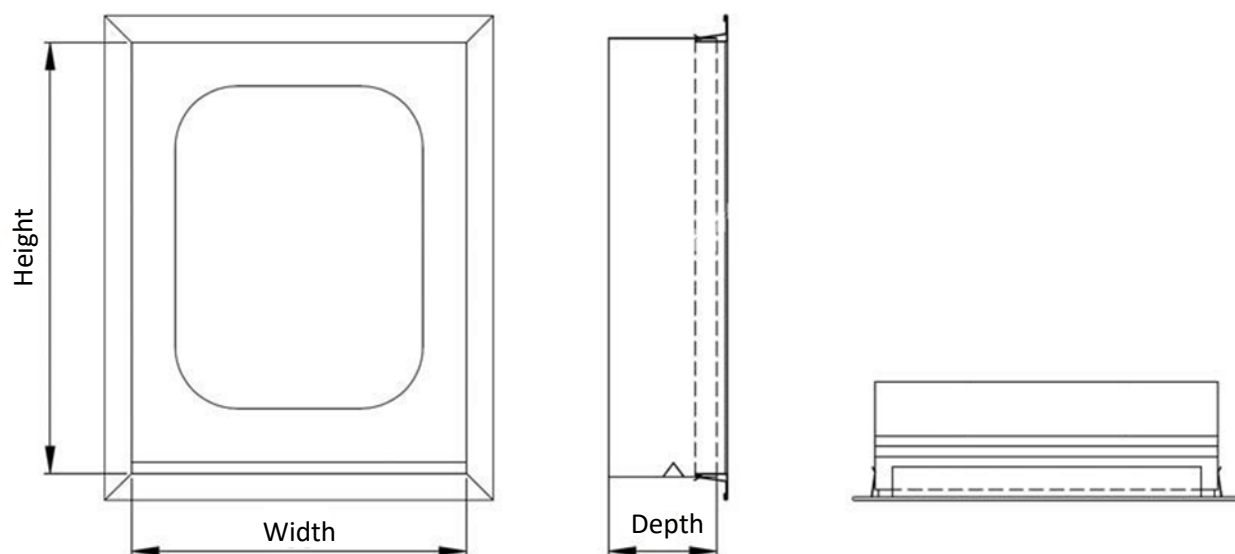

Window box		
Technical data	Steel or Stainless steel	Steel or Stainless steel
Fire classification	B-0	B-15
Element width	max. 1590 mm	max. 1590 mm
Element height	max. 1460 mm	max. 1460 mm
Element depth	According to customer specification	According to customer specification
Sliding frame	Steel or Stainless steel	Steel or Stainless steel
Weight	ca. 14,2 kg/m ² (H = 800 mm, W = 600 mm, D = 250 mm)	ca. 16,9 kg/m ² (H = 800 mm, W = 600 mm, D = 250 mm)
Density of insulation material	n/a	150 kg/m ³
Coating	varnish coated (others on request)	varnish coated (others on request)
Certification	EC, USCG	EC, USCG

Hatches for walls and ceilings

Similar to image

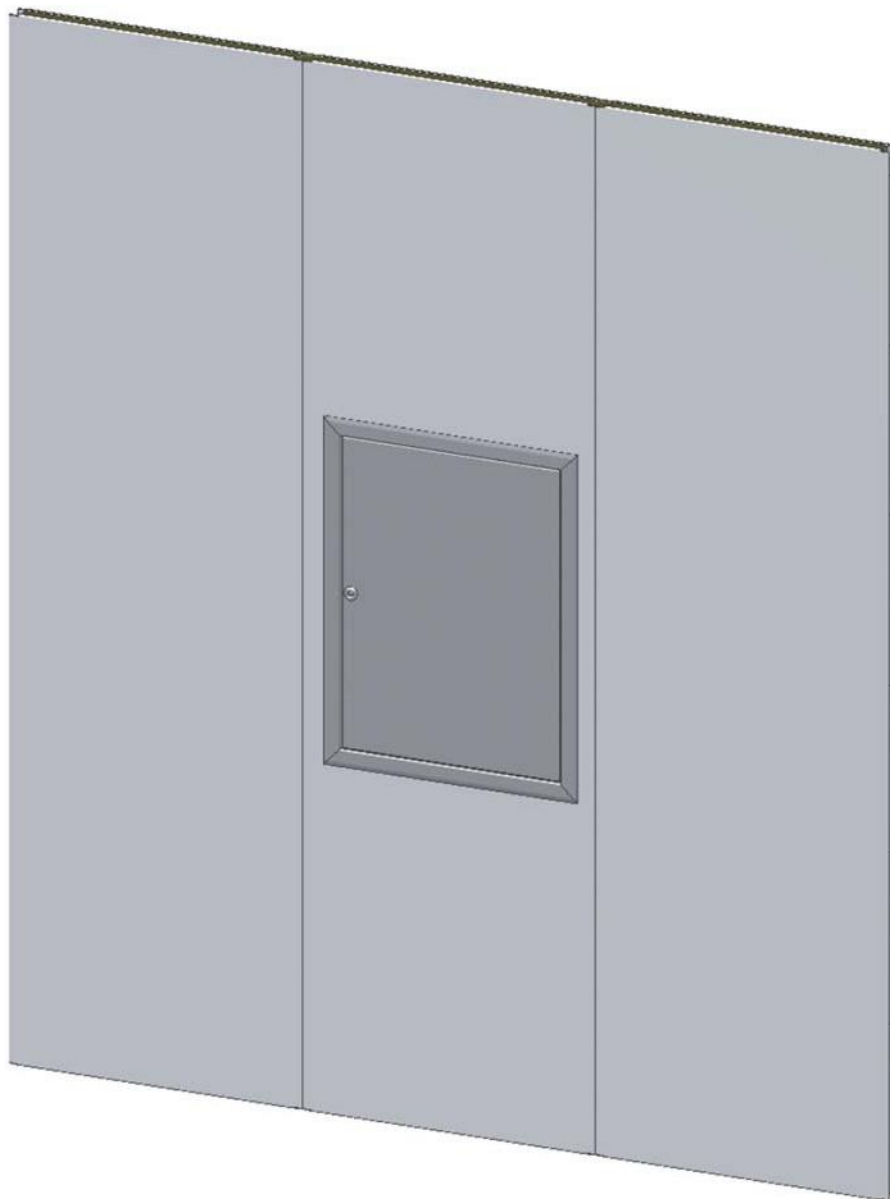

The wall and ceiling hatches with fire classification B-15 can be integrated into all wall and ceiling elements where fire protection category A or B is not stipulated, thanks to their simple design. The most diverse dimensions can be produced according to customer specifications. Depending on the length, one or two entering catches are fitted to close the hatch. For mechanical connection to the adjacent panels, the hatches come with a frame which also enhances the system's appearance. A large variety of surface finishes are available; all of them have a removable protective foil to prevent any damage from occurring during installation. All components of the hatches for walls and ceilings have been tested and approved according to international standards.

Hatches for walls and ceilings

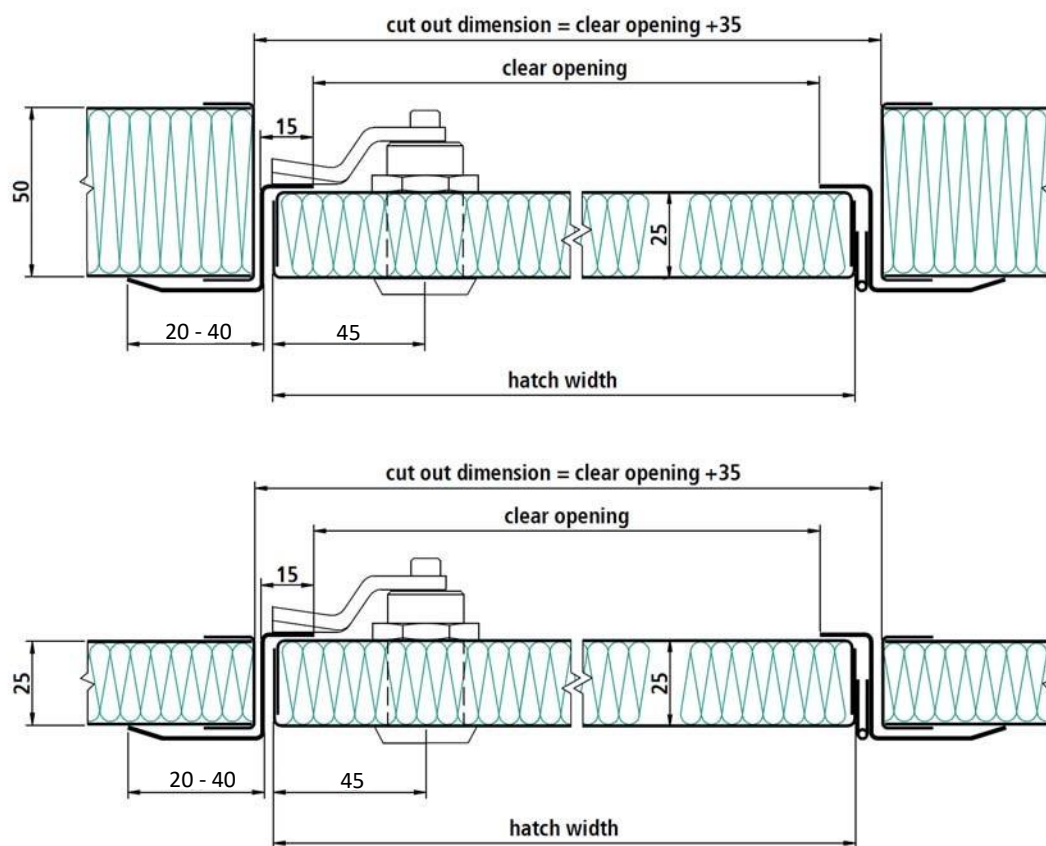

Hatches for walls and ceilings	
Technical data	Steel Steel
Fire classification	B-15
Element width	max. 680 mm
Element length	max. 1830 mm
Thickness of hatch leaf	25 mm
Mass per area	---
Density of insulation material	150 kg/m ³
Coating	PVC foil varnish coated (others on request)
Certification	EC, USCG

Integrated inspection door – SW50/SW50NF

Similar to image



Integrated inspection door – SW50/SW50NF

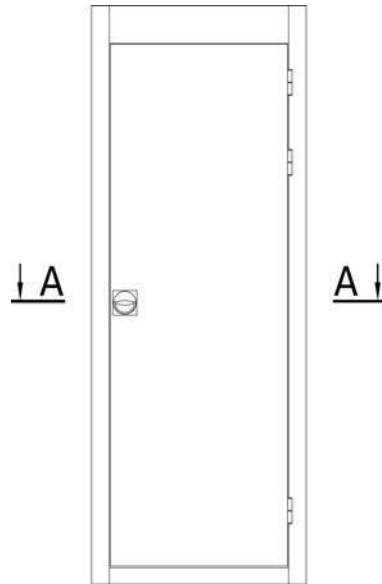

Integrated inspection door – SW50/SW50NF

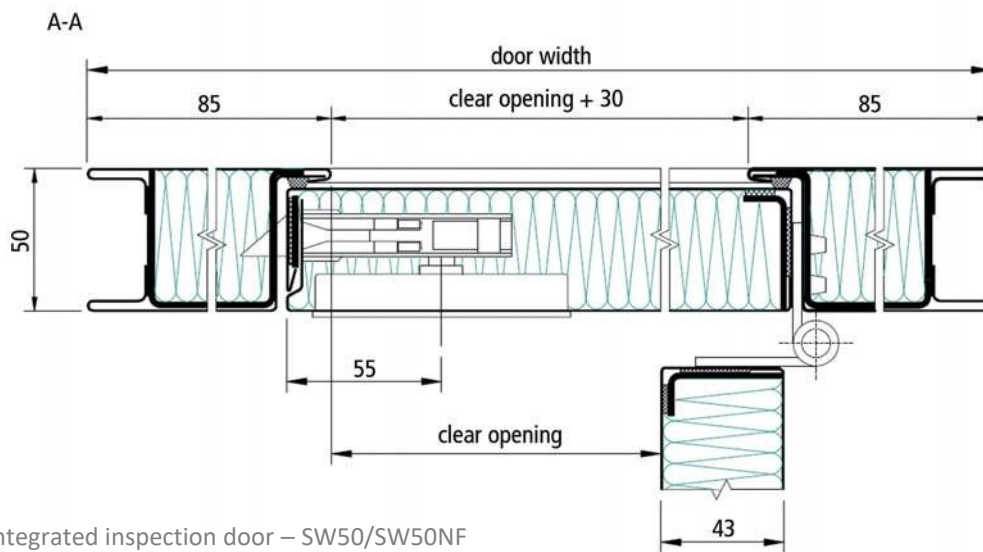

Integrated inspection door – SW50/SW50NF

The design of the SW50/SW50NF integrated inspection door is based on that of the integrated cabin door and, accordingly, it features the same properties in terms of B-15 fire classification and quality. To enable access from one side, the integrated inspection door comes with a turning handle that provides quick and simple access to areas behind the door.

A large variety of surface finishes are available; all of them have a removable protective foil to prevent any damage from occurring during installation. The design of the SW50/SW50NF integrated inspection door and all components used have been tested and approved according to international standards.

Integrated inspection door – SW50/SW50NF and SW25/SW25NF

Similar to image

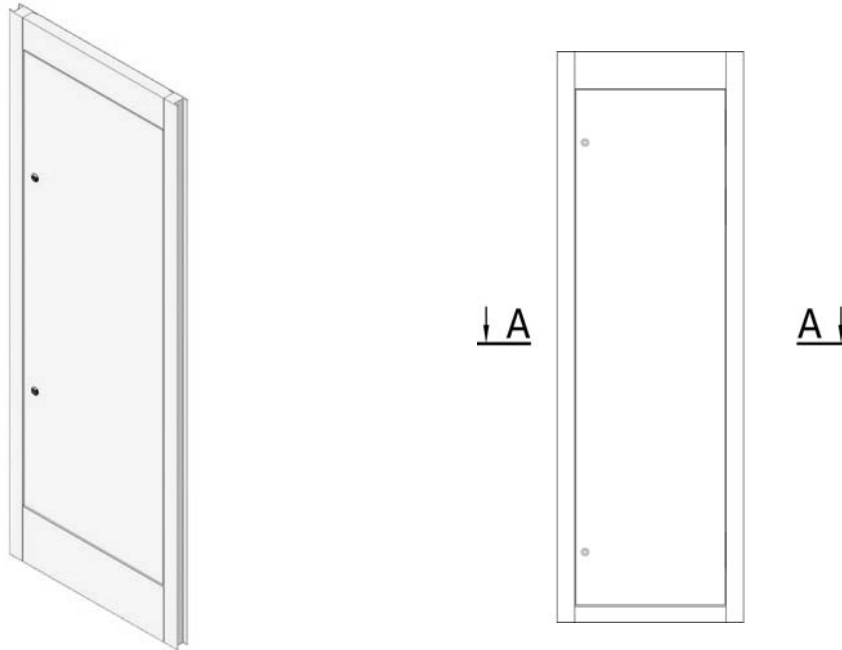

Integrated inspection door–SW50/SW50NF
and SW25/SW25NF

Integrated inspection door–SW50/SW50NF
and SW25/SW25NF

A-A

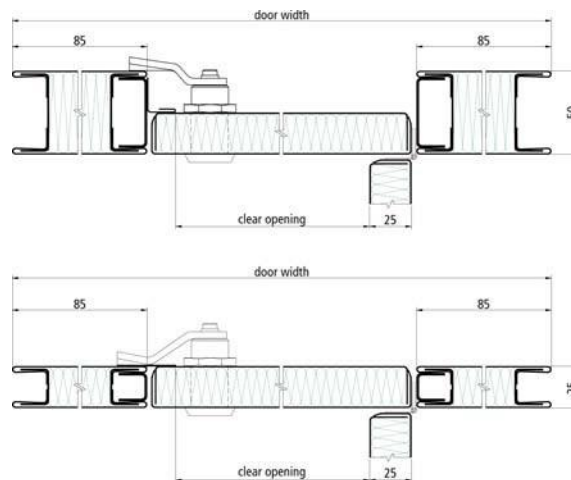

Integrated inspection door – SW50/SW50NF and SW25/SW25NF

The SW50/SW50NF and SW25/SW25NF integrated inspection door with fire classification C can be used where fire classification A or B is not stipulated but where access to areas behind the wall is required. All inspection doors come with one or two turning bolts as standard. The door can also be equipped with an optional turning handle for quick access. The door can be fitted in walls with a thickness of 25 mm and 50 mm and, thanks to its design, guarantees a smooth transition between the door and adjacent wall elements. A large variety of surface finishes are available; all of them have a removable protective foil to prevent any damage from occurring during installation. All components of the SW50/SW50NF and SW25/SW25NF integrated inspection door have been tested and approved according to international standards.

Integrated inspection door – SW50/SW50NF and SW25/SW25NF

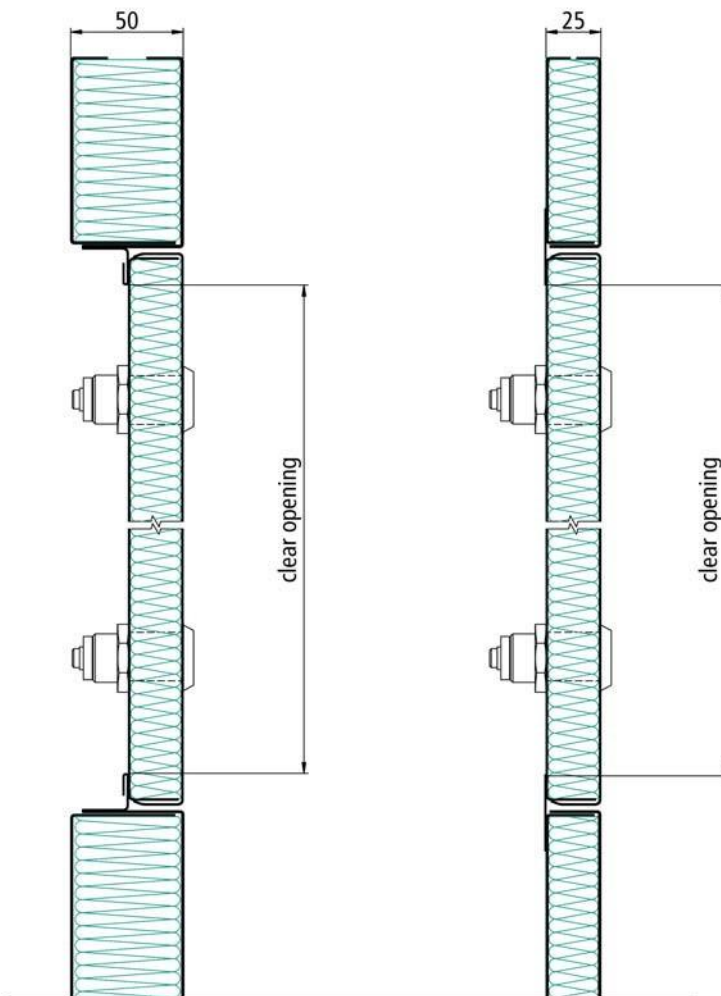

Integrated inspection door – SW50/SW50NF and SW25/SW25NF

Integrated inspection door – SW50/SW50NF and SW25/SW25NF	
Technical data	Steel Steel
Fire classification	B-15
Sound reduction according to DIN EN ISO 140-3	---
Clear opening width	max. 600 mm
Clear opening length	max. 1800 mm
Thickness of door leaf	25 mm
Density of insulation material	150 kg/m ³
Coating	PVC foil varnish coated (others on request)
Certification	n/a